



# Oben™

## CTM-2400/2500

Carbon Fiber Monopod



You're on steady ground™

### Thank you for choosing Oben™

Congratulations on the purchase of your new Oben monopod. The Oben™ CTM-2400/2500 is a versatile and durable monopod. Its carbon fiber body provides strength while being ultra lightweight. The leg features secure twist-locks for swift height adjustment.

A wrist strap is included to help secure the monopod and keep it stable during shooting.

The CTM-2400/2500 includes an leg warmer for comfortable handling in extreme weather conditions.

*Please read this entire manual before using the CTM-2400/2500 monopod.*

*Note: Images are for illustrative purposes only. Actual product may vary.*



#### Warnings:

*Do not exceed the monopod's maximum load capacity (see the product tag).*

*Ensure that all appropriate locks are engaged when necessary.*

*Monopod should only be used in temperatures ranging between -22° to 140° Fahrenheit. Do not operate in saltwater. Dry monopod if it should become wet.*

*Remove the camera from the monopod during transport.*

*Keep out of reach of children.*

### Integrated Mount

The top mount offers the option to mount a camera directly, or a ballhead can be used for greater control.

### Wrist Strap

Wrist strap for more secure handling while shooting.

### Leg Warmer

Padded leg for handling the tripod in extreme weather.

### Twist-Locks

Twist-locks provide quick and secure height adjustment.

### Retractable Spike

Integrated rubber and spiked feet for various types of terrain.

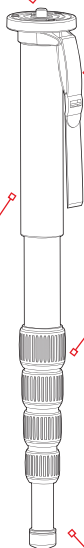

## 1. Height Adjustment

A secure twist-lock design allows for rapid height adjustment for the monopod. To adjust the height, twist the lock counter-clockwise (a), position the leg at the desired height (b), and twist the lock clockwise to secure the leg.

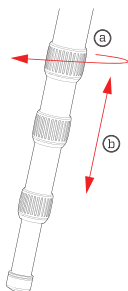

## 2. Mounting Screw

The tripod comes with a dual 3/8" and 1/4" mounting screw, allowing you to mount any tripod head or camera. To switch between the two sizes, remove the plate from the tripod by turning it counter-clockwise. Remove the screw, and insert it back into the plate in the opposite orientation. Mount the plate back onto the tripod by turning it clockwise.

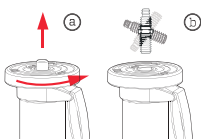

### 3. Mounting A Ballhead

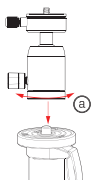

To mount the head, make sure that the tripod mount on the bottom is aligned with the tripod's mounting screw (a) and twist clockwise until fully secured. Do not over tighten, as this may cause damage to the tripod or head.

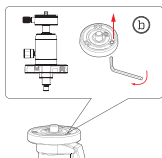

For compatible ballheads, an additional screw can be inserted underneath the mounting base (b) to prevent the ballhead from coming loose.

### 4. Hand Strap

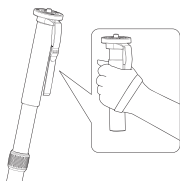

For more steady shooting, secure the hand strap around your wrist while also gripping the pad (as shown). Ensure that there is adequate tension between the strap and your wrist to increase stability.

## 5. Belt Clip

The monopod's wrist strap includes an integrated belt clip. Simply slide the clip onto a belt for hands-free transport.

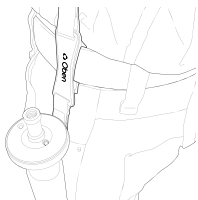

## 6. Retractable Spike

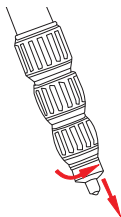

A Spike is built into the rubber foot of the monopod. The rubber part is for indoor or flat surfaces, while the spike is for soft ground, grass and sand. To extend the spike, rotate the rubber pads at the bottom of the foot clockwise. Turn the pad counter-clockwise to return the spike back into the foot.



[www.obensupports.com](http://www.obensupports.com)

© Copyright 2011 Oben Inc.

All other trademarks are the property of their respective owners